



Kelburn Normal School

APRIL 2017

Kelburn Normal School is embarking on an exciting journey to transform our campus to meet our vision for teaching and learning, now and into the future. This newsletter aims to inform and update our school community on the redevelopment project.

Construction to start soon!

Most of you will be aware that the Ministry of Education is about to build a new two level teaching block on the top court. If you are new to the school and would like further information on the property redevelopment project, please visit the [Property page](#) on the school website.

A contractor will be appointed following a competitive tender process and we expect to know the outcome this week. The chosen contractor is likely to start work within weeks and we will be working with them closely on site fencing and access arrangements. We expect most of the top court will be fenced off and that the Boundary Road school entrance will become the main construction entrance. The adventure playground and gully areas are not expected to be affected by construction activity.

You may have noticed the green spray paint on the top court — this is the new building outline so that you can see where it will be. In preparation, the relocatable buildings on the top court have been removed and the cottage has been sold to be reused — this will be removed in coming months.

We are now reasonably confident that the Ministry budget will fund the full cost of the building work and new play spaces. However, some price risks remain — for example if the foundations of the new building are more expensive than expected. The school (with partial Ministry funding) will be investing in furniture and equipment for the buildings and play spaces. We also have a few special projects for the PTA to complete and we expect to use the generous donation from the Centenary celebrations in 2014 to create a special feature (yet to be determined).

The start of construction is a major milestone. The design and funding stages were complex and challenging. We would like to thank the Ministry team, the design team, the supporting consultants, the school staff and the past and present board members (particularly Joe Bogner and Bob Walker) who with the support of the school community, have all worked to get the redevelopment this far. The construction phase will create new challenges however, the ability to remain in a teaching block separate from the main construction work area is a significant advantage.

We will be putting the plans up in the staff room window. If you have any questions, please email property@kelburnnormal.school.nz or contact our Board of Trustees Chairperson, Tim Stewart on 021 728 537.

New play spaces

A play space for our junior school will be built about where the cottage is now. Three other new play surfaces will be built: two where the old teaching block is now and the third on the 'Ngaio' site. We expect these three new play spaces will be completed by mid-2018.

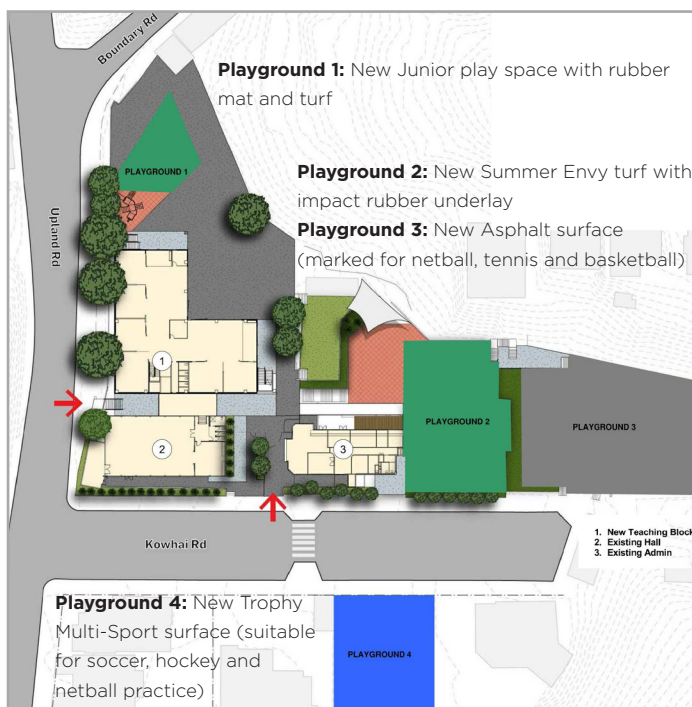

Timing of works

The new teaching block is expected to be opened for use in early 2018. At some stage during 2017/early 2018 the hall kitchen and toilet facilities will be renovated and the hall strengthened and repainted inside. We are also expecting to do some work on the Administration block. In a separate project, the Ministry of Education is adding a fairly small extension to the Visual Resource Centre building on Kowhai Road. We understand the same contractor will be completing this work as well as the work for the school.

Once the old teaching block (the multi-storied brick buildings), and the new entrants building ('Ngaio' - which is a 'leaky' building), are no longer needed they will be demolished. We expect this to occur in early 2018. The wooden Administration block with its music rooms and room 14, the hall and the PTA shed will all remain.